

B

CUT 1 = 180.000mc

A

CUT 1 = 560.000mc
FILL 1 = 180.000mc

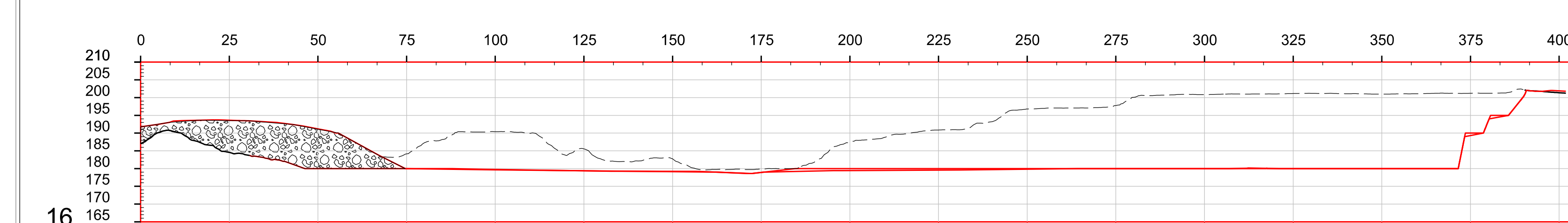
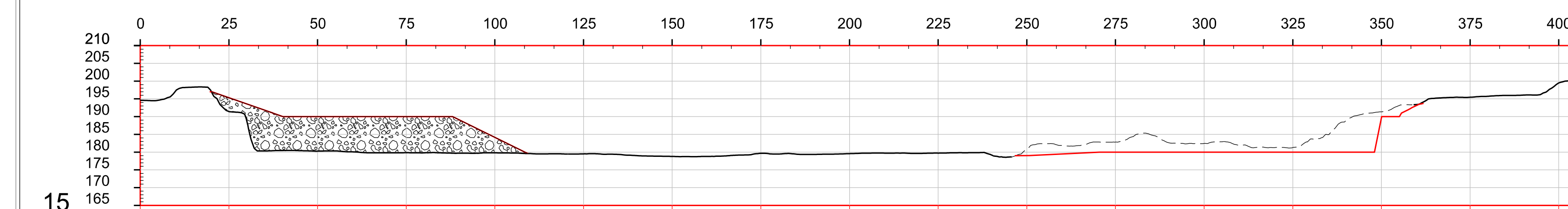
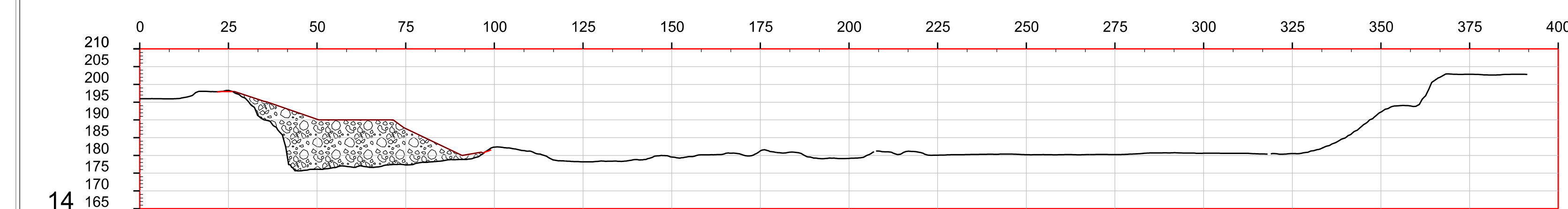
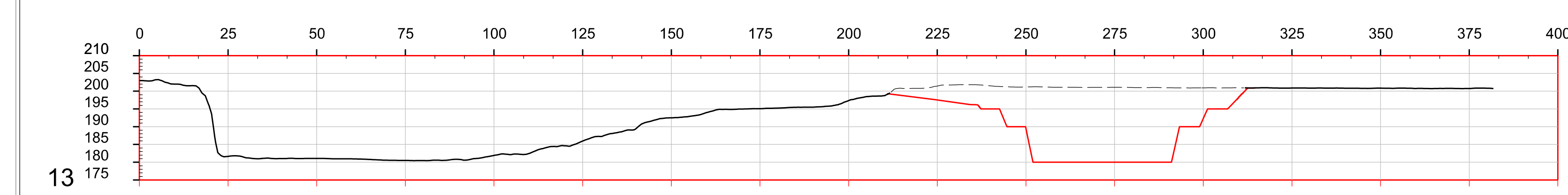
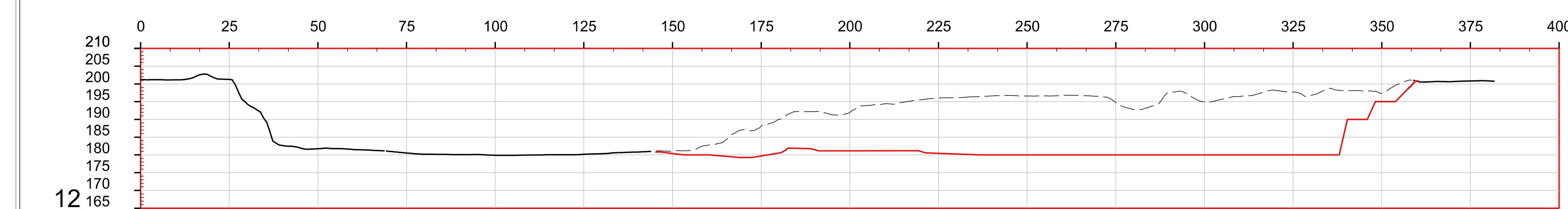
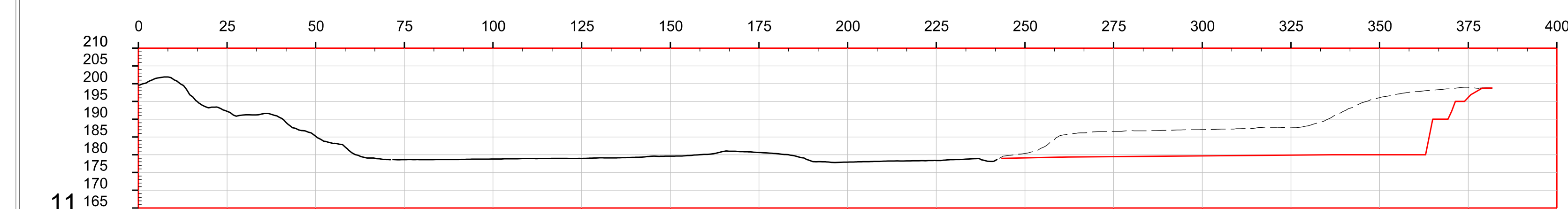
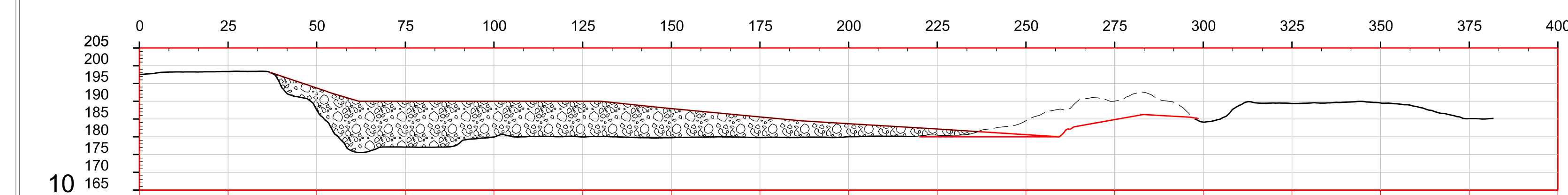
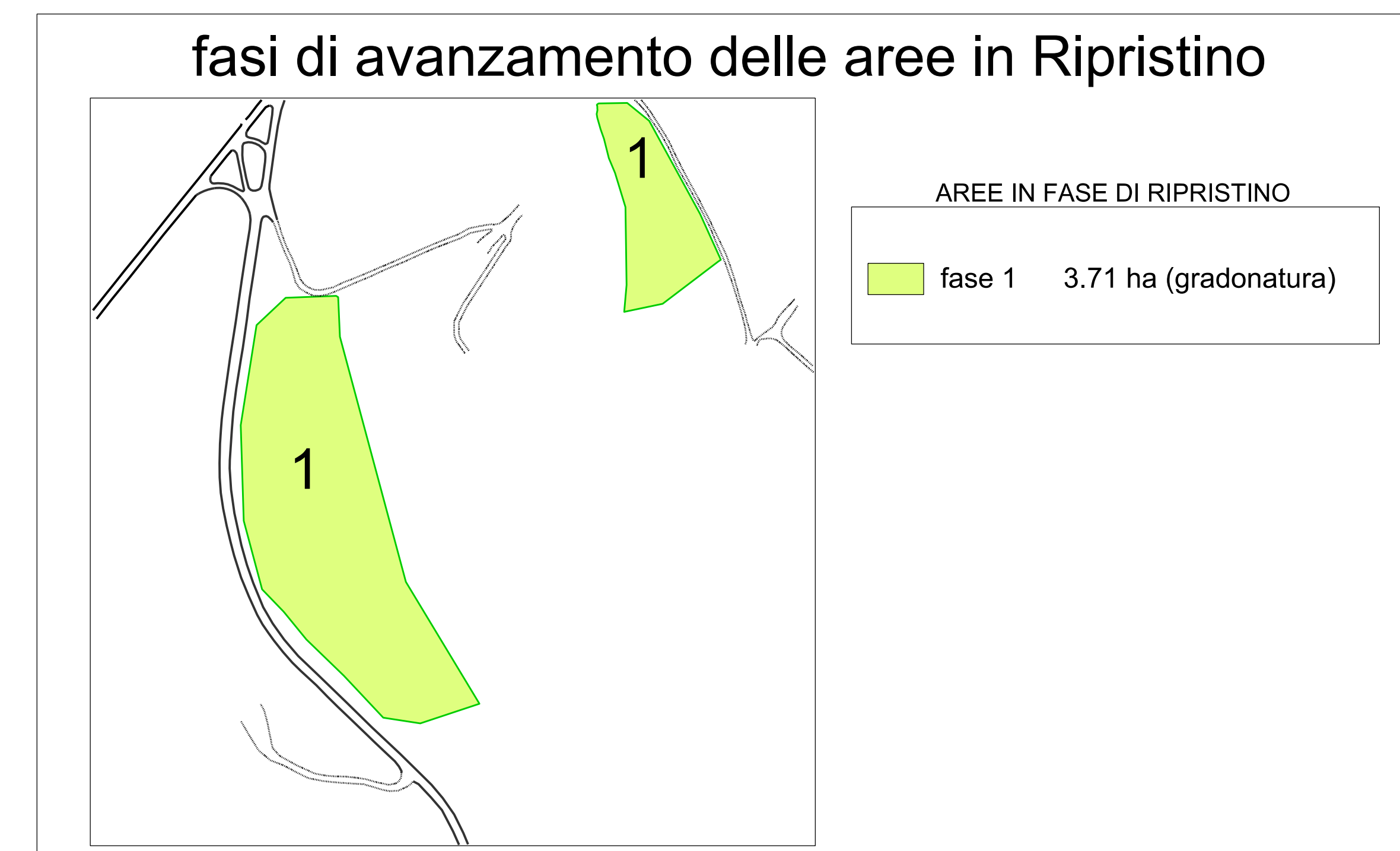
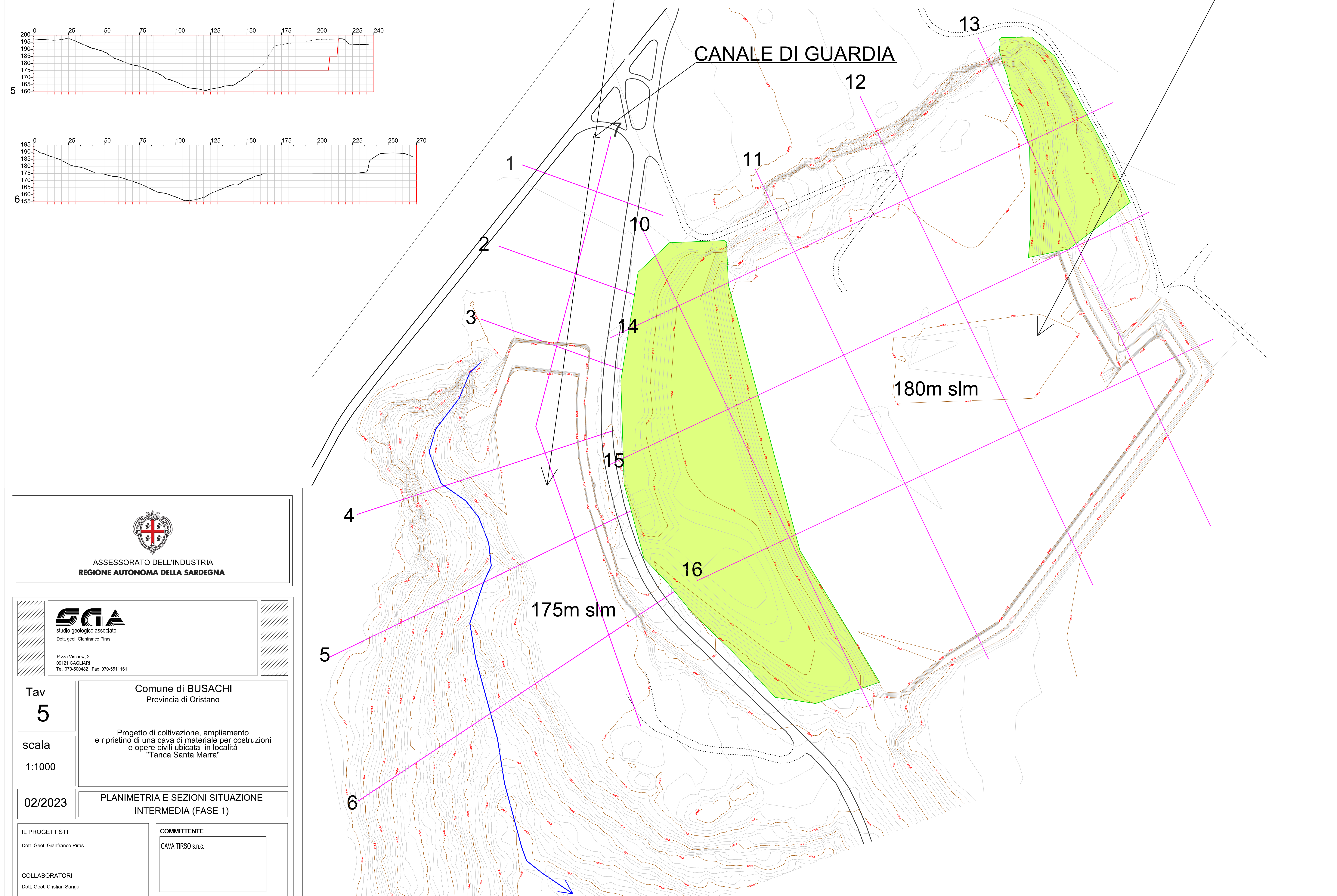



ASSESSORATO DELL'INDUSTRIA
REGIONE AUTONOMA DELLA SARDEGNA



studio geologico associato
Dott. geol. Gianfranco Piras

P.zza Vittoria, 2
09121 CAGLIARI
Tel. 070-500482 Fax 070-5511161

Tav
5

scala
1:1000

Comune di BUSACHI
Provincia di Oristano

Progetto di coltivazione, ampliamento
e ripristino di una cava di materiale per costruzioni
e opere civili ubicata in località
"Tanca Santa Marra"

02/2023

PLANIMETRIA E SEZIONI SITUAZIONE
INTERMEDIA (FASE 1)

IL PROGETTISTI
Dott. Geol. Gianfranco Piras

COLLABORATORI
Dott. Geol. Cristian Sarigu

COMMITTENTE
CAVA TIRSO s.r.l.